

REGISTRATION FILE

RETURN IT BEFORE APRIL 16TH 2021

The city of Mulhouse organizes **mulhouse 021**, at MOTOCO from the 17th to the 20th of September 2021. The registration file is composed:

- **The registration form**
- **The technical registration form:** you choose one exhibition space which corresponds to your installation. You map your installation on a plan and make sure you have answered all questions.
- **A CV with a selection of detailed works under the shape of photos (maximum 15) with description of the works if necessary. If candidate displays videos, they should be imperatively on USB support.** It is necessary to add one synopsis or one short summary

IMPORTANT :

- Make sure that the cultural department of the City of Mulhouse has received your documents within the deadline mentioned above. (tel: +0033.3.69.77.77.50)
- Registration file received after April 16th 2021 will be not studied.

Return the completed registration file before the April 16th 2021:

By e-mail to:

Elodie.mosnier@mulhouse-alsace.fr (pdf file)

OR

By post to:

Madame Anne-Catherine Goetz
Adjointe au Maire chargée de la culture
Ville de Mulhouse - Service Développement Culturel
2 rue Pierre et Marie Curie - B.P. 10020
68948 Mulhouse Cedex 9

REGISTRATION FORM

EXHIBITOR'S IDENTIFICATION

Man

Woman

Name First name

Adress

P.O Box City

Phone Nbr

E-mail

Name of the Art High school

.....

Adress

P.O Box City

Phone Nbr

Year of graduation

I undersigned undertakes to participate at said manifestation and agrees with its regulations and with installation instructions (annexed documents).

I authorize / do not authorize the City of Mulhouse to exploit photos or representation of my works for distribution to the national, international, specialized magazines (***please cross out whichever does not apply***).

Signature:

CHOICE OF EXHIBITION SPACE

- Thanks to select only one exhibition space
- Clearly indicate the characteristics on the next page
- You map your installation on a plan
- Indicate clearly, the type of space and the location of the space

Example : *ground floor / space of type 1*

First floor / space of type 3 / room n°24.

Location	Ground floor
	First floor
	Second floor

Type of space	Space of type 1 (ground floor 20 m ²)
	Space of type 2 (ground floor 80m ²)
	Space of type 3 (room in floor) Indicate the number of the room : _____

Scaffold (only for ground floor) yes no

If yes for: the set up / the dismantling

Please indicate the estimated time: _____ minutes/hours

On site storage yes no

if yes : area (m²) : _____

On site storage from Wednesday June 9th 2021 evening until Wednesday June 16th 2021 morning (as of article 9 of the rules, the insurance that was taken out is valid from Thursday June 8th 2021 8 am until Wednesday June 16th 2021 12 am).

Fastening of an item weighing more than 30 kg requiring specific hanging (if yes, please to make appear on the plan): yes no

GROUND FLOOR

Space of type 1: 26 spaces of 20 m² in ground floor (more of 4m high, raw concrete floor)

or

Space of type 2: 4 spaces of 80 m² in ground floor (more of 4m high, raw concrete floor)

All of the spaces located at the edge of the exterior walls of the building have windows facing the exterior (daylight).

It's not possible to hand on your exterior walls in the ground floor.

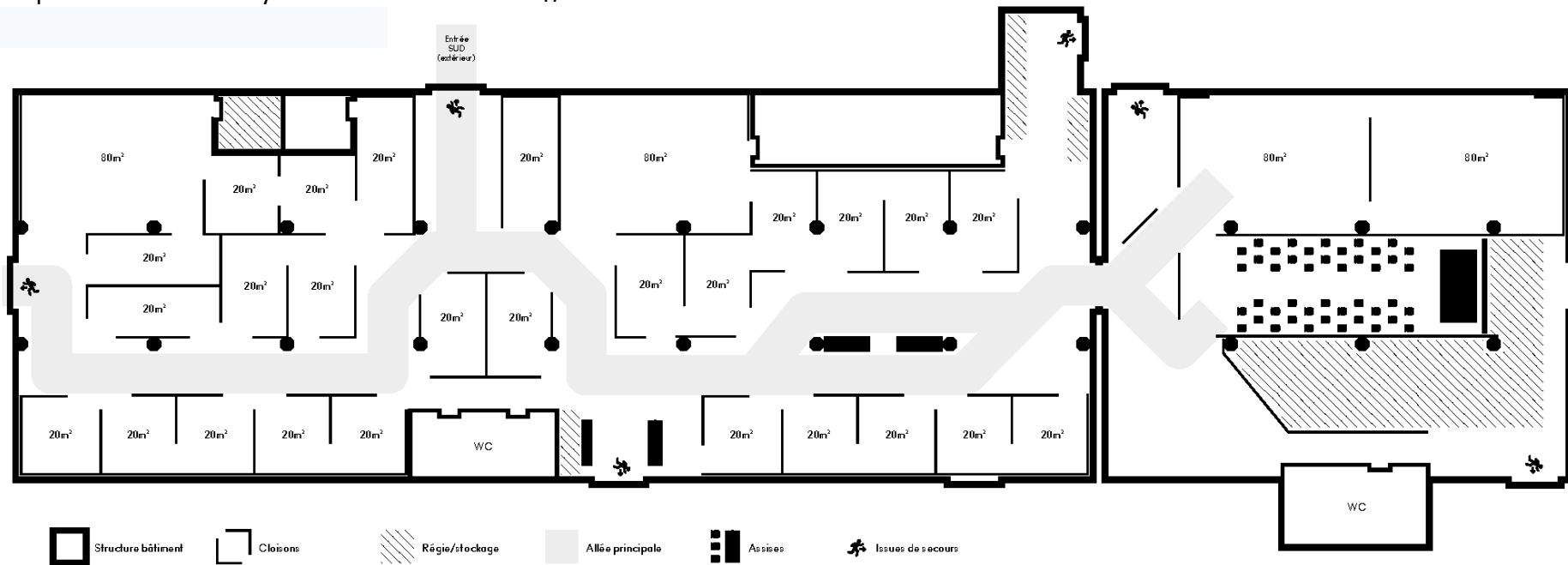

Characteristics of the space:

Electric power:

3Kw

other: ____

Lighting (3spots maxi):

yes, how many spot ____ indicate their position on the plan)

no

Need to hang from the ceiling:

yes

no

Need for video projection:

yes

no

Need for tables and chairs:

yes how many: ____

no

FIRST FLOOR: be careful, no elevator, no freight elevator

Space of type 3: room in floor, 14 spaces, from 20 m² to 70 m², variable ceiling between 4m and 2.50m high, different floors, all different and can be visited virtually at the [following address](#)



Characteristics of the space:

Lighting (3spots maxi):

yes, how many spot ____ indicate their position on the plan)

no

Need to hang from the ceiling:

yes

no

Need full black:

yes

no

Need for tables and chairs:

yes how many: ____

no

SECOND FLOOR: be careful, no elevator, no freight elevator

Space of type 3: room in floor, 16 spaces, from 16 m² to 80 m², variable ceiling between 4m and 2.50m high, different floors, all different and can be visited virtually at the [following address](#)



Characteristics of the space:

- | | | |
|--------------------------------|-----------------------------------------------------------------------------------|--------------------------|
| Lighting (3spots maxi): | <input type="radio"/> yes, how many spot ___ indicate their position on the plan) | <input type="radio"/> no |
| Need to hang from the ceiling: | <input type="radio"/> yes | <input type="radio"/> no |
| Need full black: | <input type="radio"/> yes | <input type="radio"/> no |
| Need for tables and chairs: | <input type="radio"/> yes how many : ___ | <input type="radio"/> no |

THE PLACE : motoco

Motoco takes place in an industrial building (building 75), almost 9000m², located in the heart of an industrial site in complete renewal in Mulhouse. Motoco is a working place, an artistic, cultural and multidisciplinary space, with almost 140 resident artists and craftspeople, who experiment every day new ways of living their creative activity, by pooling tools, knowledge, material resources or humans, in the collective interest.

By advocating artistic eclecticism and the diversity of audiences, motoco provides their resident with private workshops at very reduces prices and shared spaces and tools for creation and conviviality. Space of social, artiste, cultural, economic and unique urban experiences in Alsace, motoco is a community that ventures into new forms of expression and collaboration, choosing openness and diversity rather than withdrawal.

Involved in support and development of artistic and creative activities for the common good, heritage conservation and transformation of industrial wasteland, motoco wants to develop the partnerships established for nearly 3 years, to perpetuate its action in favor of the territory, and to place sustainably this site as reference in the economic, cultural and identity cooperation of the south Alsace, at the heart of the three border region and of Europe.

Motoco hosts a dozen nationalities (30% of foreigners), an incubator managed by the HEAR (Haute Ecole des Arts du Rhin), foreign residents managed by the Kunsthalle (art center of Mulhouse), an image pole, a screen printing pole, a carpentry area and two large spaces for events.

The building 75, which houses the motoco project, has three floors with different activities:

- Ground floor : two rooms for events (capacity of 1200 people) and image and screen printing poles
- First and second floor : 92 workshops from 10 to 200m²

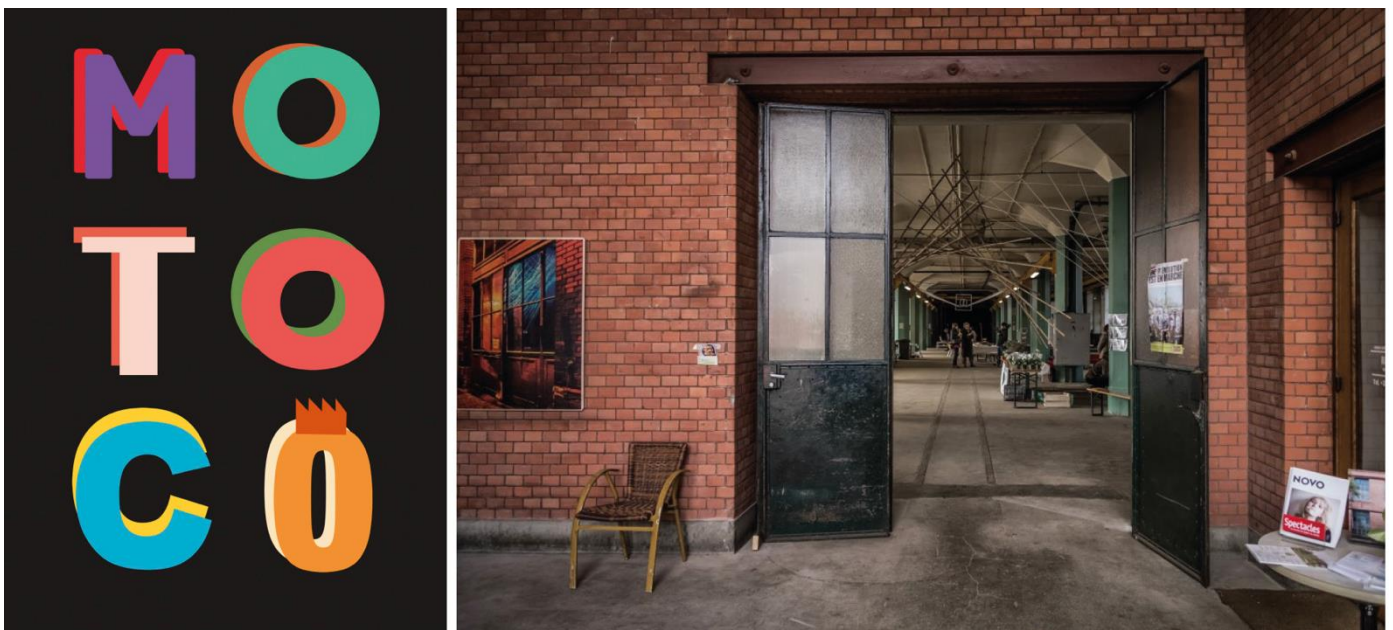



Contacts :

**City of Mulhouse
Cultural Office**

Elodie MOSNIER
03.69.77.77.50
elodie.mosnier@mulhouse-alsace.fr

MOTOCO

Martine ZUSSY
06.36.56.60.98
martine@motoco.fr